

The floor plan of the 1st floor of the Kanazawa City Library Sefuri Branch is as follows:

- Top Section:**
  - 神崎市立図書館 脊振分館 (Kanzaki City Library Sefuri Branch):** Located at the top left, featuring a book icon.
  - 放課後児童クラブ (After School Kids Club):** Located below the library, featuring a backpack icon.
  - 多目的室1 (Multi-purpose Room 1):** Located below the club, featuring a table and chairs icon.
- Right Section:**
  - 市民ホール (Civic Hall):** Located on the right side of the plan.
  - 入口 (Entrance):** Located at the top right, with a downward arrow.
- Bottom Section:**
  - 時間外受付 (Out-of-hours Reception):** Located at the bottom left.
  - 会計 (Cashier):** Located below the reception area.
  - 脊振支所・公民館 (Sefuri Branch Office/Community Center):** Located at the bottom, featuring a document icon.
  - 相談室 (Counseling Room):** Located on the bottom right, with a vertical label.
- Central and Other Features:**
  - Stairs:** Indicated by a staircase icon in the center.
  - Facilities:** Various icons for a bicycle rack, a red fire alarm, a blue person icon, a wheelchair icon, a baby bottle, a family group, and a person with a backpack.
  - Entrances:** Additional entrances are marked with arrows on the left and right sides.

The floor plan of the 2nd floor includes the following rooms and areas:

- 調理実習室 (Cooking Room):** Located at the top left, featuring a chef's hat icon.
- 多目的室2-3 (Multi-purpose Room):** Located below the Cooking Room, featuring a crown icon with the number 2-3. It includes a red fire alarm pull station.
- 和室 (Tatami Room):** Located below the Multi-purpose Room 2-3, featuring a bowl icon. It includes a blue fire alarm pull station.
- 多目的室2-2 (Multi-purpose Room):** Located at the bottom left, featuring a crown icon with the number 2-2.
- 多目的室2-1 (Multi-purpose Room):** Located at the bottom right, featuring a crown icon with the number 2-1.
- ラウンジ (Lounge):** Located on the right side of the floor plan.
- Restrooms:** A row of restrooms is located between the Tatami Room and the Multi-purpose Rooms 2-1 and 2-2, including a wheelchair-accessible toilet and a family restroom.
- Staircase:** A staircase is located between the Cooking Room and the Multi-purpose Room 2-3.
- Corridor:** A long corridor runs along the right side of the floor plan, adjacent to the Lounge.

The floor plan of the 3rd floor is divided into three main sections. The top section contains '大会議室 3-1' (Conference Room 3-1) with a capacity of 3-1. The middle section contains '大会議室 3-2' (Conference Room 3-2) with a capacity of 3-2. The bottom section is a reception area with a 'RECEPTION' sign, a 'Y' logo, and a '3F' indicator. There are also icons for a wheelchair and a person with a backpack. The floor number '3F' is displayed in the bottom right corner.

3

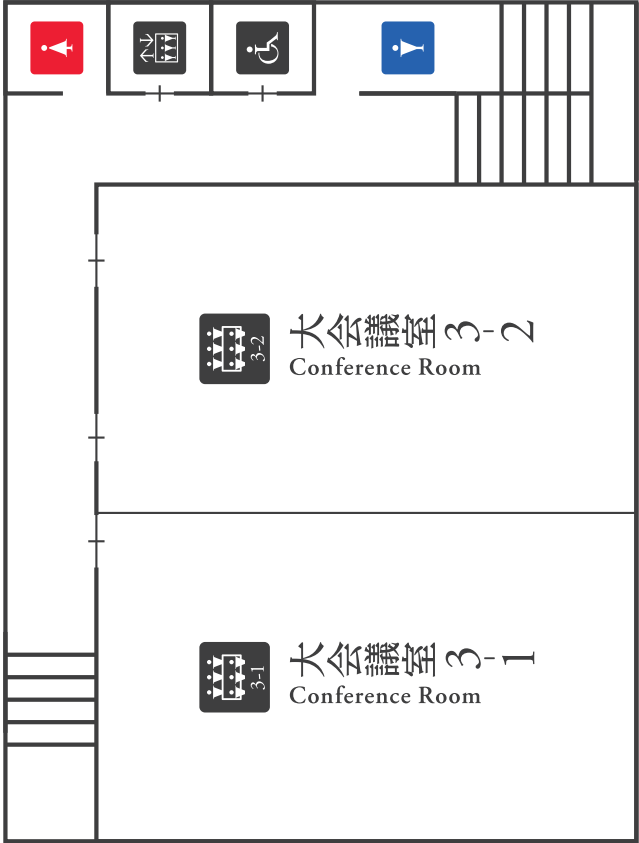

2

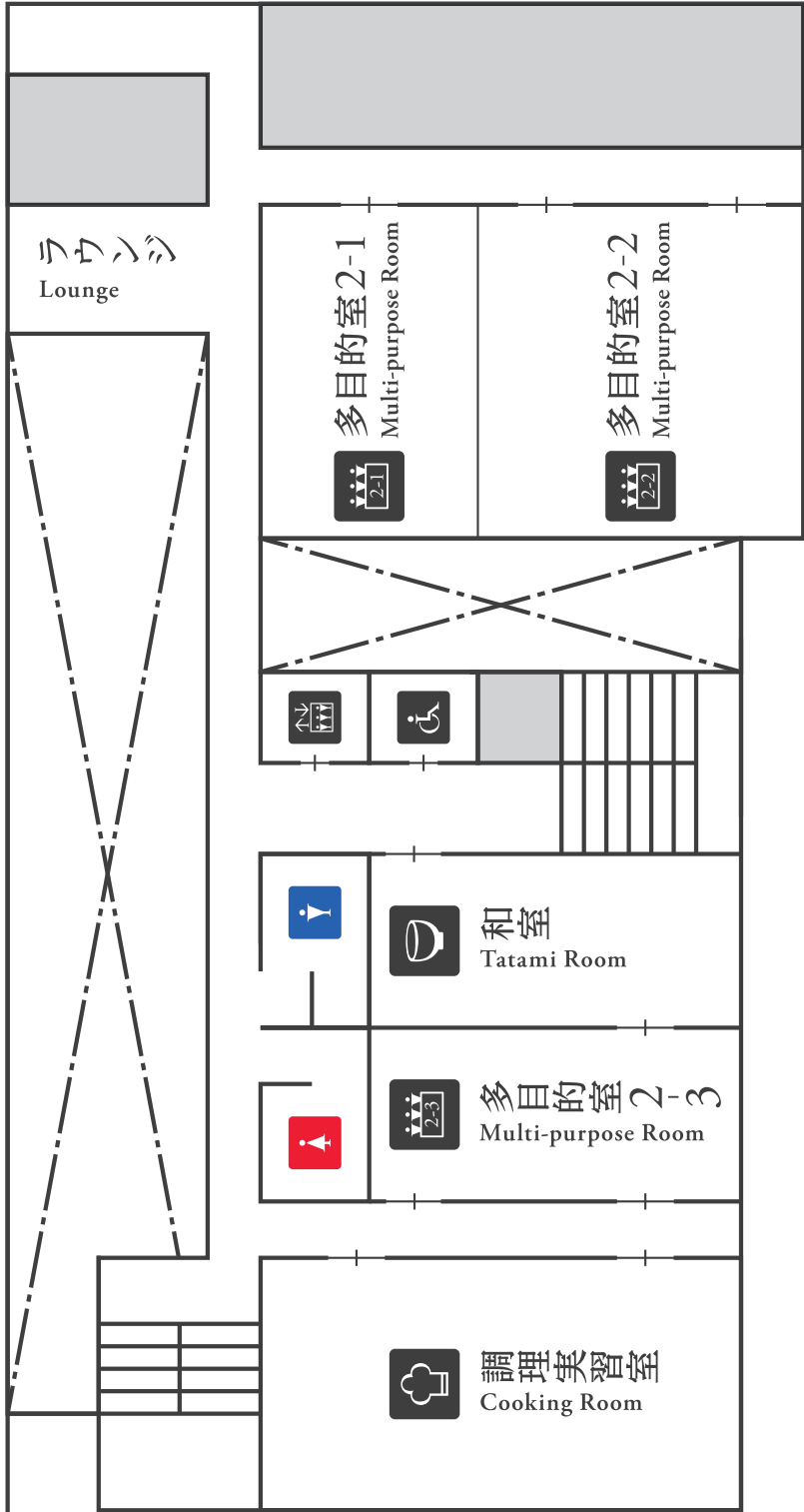

1

